

Fast Trak® - Standard



Pre-fabricated bracket solution offering speed, flexibility and efficient use of space, for the installation of electrical containment, pipework, ductwork and other mechanical services in restricted places.

FEATURES / BENEFITS

- **Quick** – up to six times faster to install than traditional suspension systems
- **Safe** – pre-fabricated system which removes the need to cut threaded rod or channel on-site
- **Tool free adjustment** – bracket can be moved up and down the tracks to accommodate changes in position during installation
- **Zero waste** – tracks bend neatly under bracket*
- **Versatile** – four-sided bracket provides suspension point on every face; ideal for installation of combined bracketry and multi-tiered configuration to accommodate additional services
- **Easy measurement** – indicators at each end of the bracket offer measurement guide when marking fixing points on the ceiling; M4 level markers on the tracks highlight 50 mm increments, no leveling tools required
- **Neat & tidy** – system can be 'stacked' on-site to reduce storage requirements
- **Fire tested** – to F120 to the temperatures associated with BS EN 1363-1:2012. Independent test data with load limits and exposure times is available upon request from Gripple Technical Services.



INSTALLATION & ADJUSTMENT

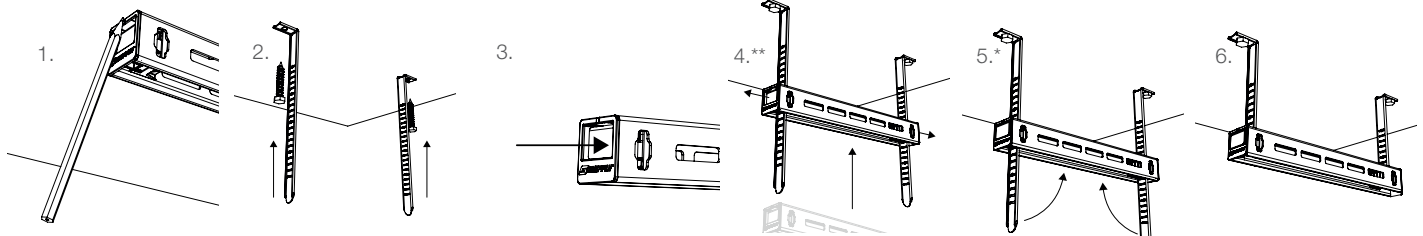

Internal applications only. Do not adjust under load. No dynamic loading. Single use only. **When installed correctly, button must be fully retracted and flush with the cartridge edge.
*Excess tracks can also be snapped off once bracket is levelled & secured for a neater finish. Bending tracks by hand is not recommended when excess is under 100 mm.

SPECIFICATION

Bracket

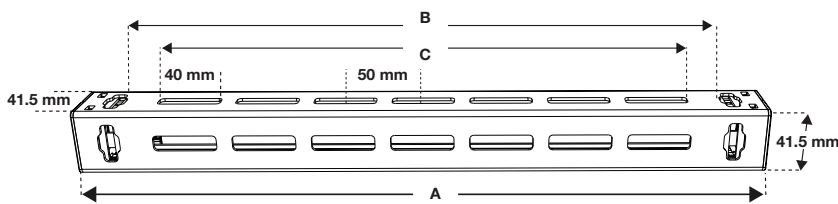

Bracket	FTB-170	FTB-270	FTB-370	FTB-470	FTB-570	FTB-670	FTB-770
A (mm) Length	239	339	439	539	639	739	839
B (mm) Suspension Space	176	276	376	476	576	676	776
C (mm) Working Space	140	240	340	440	540	640	740
No. of Slots	3	5	7	9	11	13	15

Bracket	FTB-870	FTB-970	FTB-1070	FTB-1170	FTB-1270	FTB-1370	FTB-1470
A (mm) Length	939	1039	1139	1239	1339	1439	1539
B (mm) Suspension Space	876	976	1076	1176	1276	1376	1476
C (mm) Working Space	840	940	1040	1140	1240	1340	1440
No. of Slots	17	19	21	23	25	27	29

Track

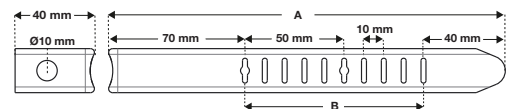

Track	A (mm)	B (mm)
FTT-200	200	90
FTT-300	300	190
FTT-400	400	290
FTT-500	500	390
FTT-600	600	490
FTT-700	700	590
FTT-800	800	690
FTT-900	900	790
FTT-1000	1000	890
FTT-1100	1100	990
FTT-1200	1200	1090
FTT-1300	1300	1190
FTT-1400	1400	1290
FTT-1500	1500	1390

SUBMITTAL INFORMATION

Safe Working Load:

System rating: Up to 200 kg @ 3:1

*Load rating performance at ambient temperatures - for fire performance, please contact your sales representative or email TechnicalServices@gripple.com. See table on reverse page for maximum working loads at ambient temperatures.

Material:

Track & Bracket Material – BS EN 10346:2009 DX51D (Mild Steel, Pre-Galv Z275)

Cartridge Housing – ABS Plastic

Spring – BS 2056 Austenitic 302S26 G2

Latch – EN 10346 S450GD

Approvals:

Lloyds certified

UL tested

TÜV tested

APAVE tested

Fire tested by Exova to F120 & MPA to 1363-1

PI-FASTTRAK-STANDARD-ENG

Published 06/21

www.gripple.com



Gripple's policy is one of continuous development and innovation. We therefore reserve the right to alter specifications, etc. without notice.

Gripple Ltd | The Old West Gun Works | Savile Street East | Sheffield S4 7UQ
Tel 0800 018 4264 Fax 0114 275 1155 Email info@gripple.com

Maximum Working Load (kg/kN)*

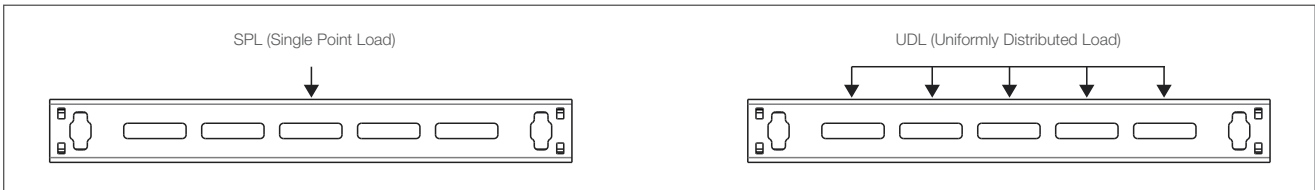

FTB-270 to FTB-1370

Bracket Orientation**	'n' orientation		'c' orientation	
	kg	kN	kg	kN
Single Point Load (SPL) @ 3:1	100 kg	0.98 kN	70 kg	0.68 kN
Uniformly Distributed Load (UDL) @ 3:1	200 kg	1.96 kN	130 kg	1.27 kN

FTB-1470

Single Point Load (SPL) @ 3:1	100 kg	0.98 kN	70 kg	0.68 kN
Uniformly Distributed Load (UDL) @ 3:1	175 kg	1.71 kN	130 kg	1.27 kN

*For more details on specified loads or additional deflection ratings please contact Gripple Technical Services. When loading multiple faces the total load applied must not exceed the values stated.

**Can also be installed in a 'u' orientation but a Fire Fastener must be used to retain fire rating. Contact Gripple Technical Services for more information on this application.